

Steel pipe socket and half socket, equal, type heavy

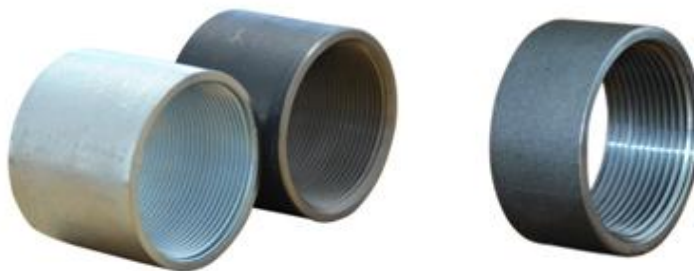
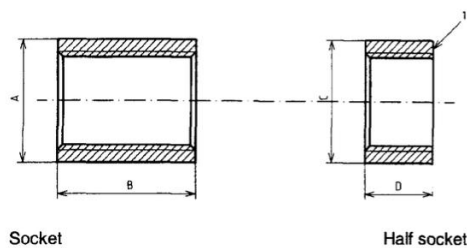

Nominal size	O.D.	Length	O.D.	Length
DN	A mm	B mm	C mm	D mm
6	15.0	19	15.0	8
8	18.5	27	18.5	11
10	22.0	28	22.0	12
15	27.0	37	27.0	16
20	32.5	39	32.5	19
25	39.5	46	39.5	21
32	49.0	51	49.0	25
40	56.0	51	56.0	25
50	68.0	60	68.0	28
65	84.0	69	84.0	30
80	98.0	75	98.0	35
100	124.0	87	124.0	40
125	151.0	96	151.0	44
150	177.0	96	177.0	44

Steel Pipe Sockets Conforms to BS1387 ,EN10241

Material: Seamless steel pipe

Thread: DIN2999,ISO7/1,BS21

Finish: Black or Galvanized